

COMPACT 38N hinges



Features

- Steel, nickel plated
- 105° opening angle
- One piece assembly
- Wrap around or edge mount
- 7/16" cup depth
- $\pm 1/8$ " height adjustment
- $\pm 1/16$ " side adjustment
- $+3/32$ " $-1/32$ " cam depth adjustment

Minimum reveal

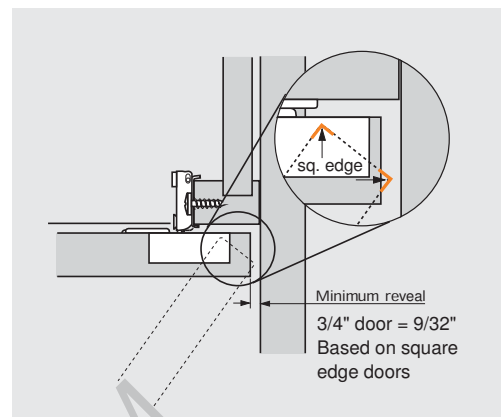



General specs & installation
Cover caps

page 65

page 72

Overlay application

Wrap around	3/8"	7/16"	1/2"	5/8"	3/4"
Screw-on	38N355C.06	38N355C.07	38N355C.08	38N355C.10	38N355C.12
Press-in 	38N358C.06	38N358C.07	38N358C.08	38N358C.10	38N358C.12
Edge mount	1/2"				
Screw-on	38N355CE08				
Press-in 	38N358CE08				

Attachment

Wrap around

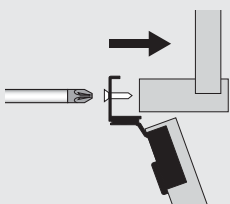

Edge mount

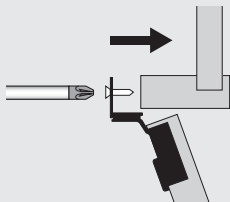

Wood screws



#10 x 3/4" pilot bore

1034N



#8 x 3/4" type 17

834TH

Adjustment

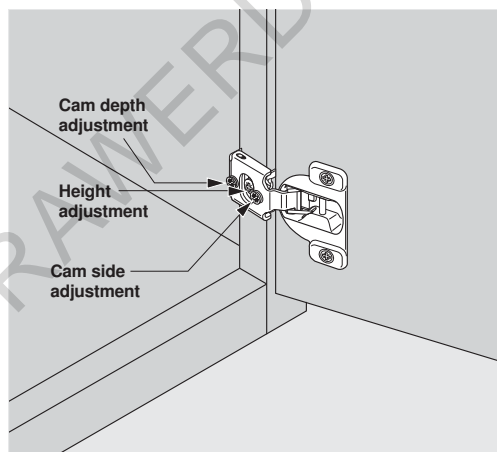

Boring pattern

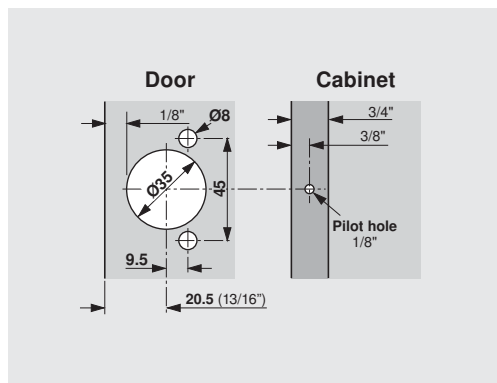

Dimensions

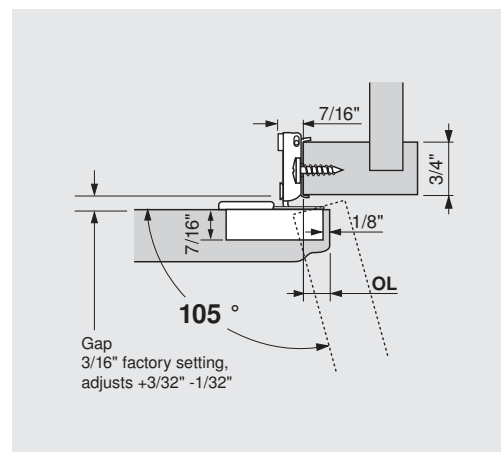

Door protrusion

OL	P
3/8"	1/4"
7/16"	3/16"
1/2"	1/8"
5/8"	0
3/4"	0

OL = Door overlay
P = Door Protrusion

COMPACT