

# Pull-out surround

## For interior pull-out tray organization

- 1 & 2 Standard runner set:**  
L&R cabinet and drawer profiles  
Colors: cream or white

	Drawer length
<b>230M3500</b>	<b>350</b> (13-3/4")
<b>230M4000</b>	<b>400</b> (15-3/4")
<b>230M4500</b>	<b>450</b> (17-11/16")
<b>230M5000</b>	<b>500</b> (19-11/16")
<b>230M5500</b>	<b>550</b> (21-5/8")

- 3 ZTU.0020 Double corner support**  
synthetic, cream or white
- 4 ZRG.1104U Gallery rails, 1104 (44") long**  
cream or white, cut to length
- 5 ZRU.00E0.01 Single gallery connector**  
synthetic, cream or white
- 6 ZRU.00Z0.01 Double gallery connector**  
synthetic, cream or white

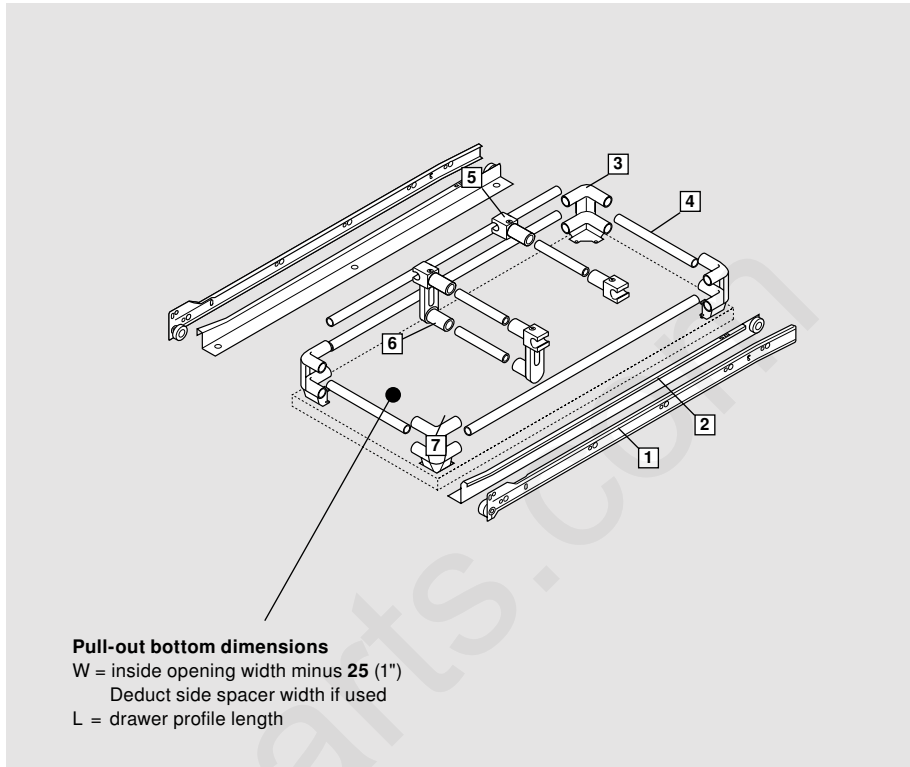

## Assembly and installation specifications

### For pull-out surround assembly

The pull-out surround drilling gauge enables pre-boreing of the fixing positions for the corner supports.

Includes:

- (3) special  $\varnothing 2.5$  drill bits
- (1) #2 Phillips, long screwdriver blade

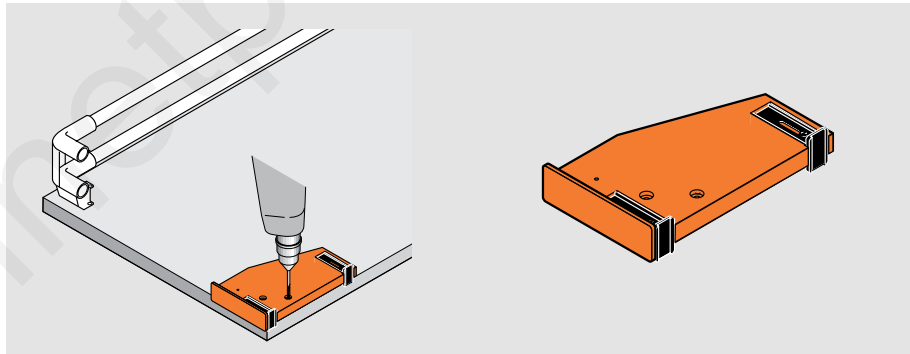

**ZML.0010** Drilling gauge

