

## Drawer front adjuster

Nylon housing with pre-mounted 8-32 steel nut. For four-sided drawers. Adjusts height and side-to-side by 5 (3/16").

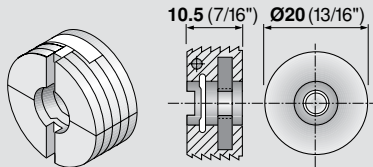

**NOTE:** See next page for marking gauge

Part no.

POZI installation screw

**661.1300.HG**

## Using the drawer front adjuster

**1** Insert drawer front adjusters manually or with a MINIPRESS insertion ram (MZM.0095)

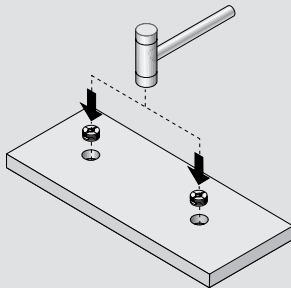

**2** Install and adjust drawer front

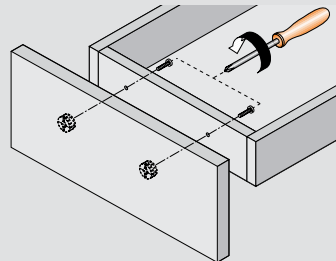

[www.thedrawerdepot.com](http://www.thedrawerdepot.com)