

# TANDEM depth adjustable locking device

## Product



## Description

- Designed for better alignment of inset drawer fronts by providing precise depth adjustment
- Adjustable stop preset at **0mm** allows the drawer to be adjusted out up to **4mm** (3/16")
- Self-locking depth adjustment screw maintains depth setting
- Adjustments can be made with the drawer installed
- For use with TANDEM plus 562 H/F (BLUMOTION recommended)

Left **T51.1700.PV L**  
Right **T51.1700.PV R**

## Application

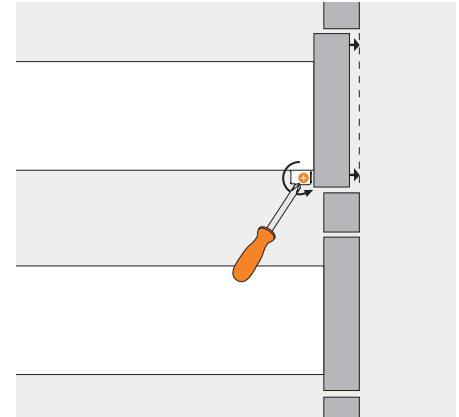

## Installation

### Mounting the TANDEM profile for inset application

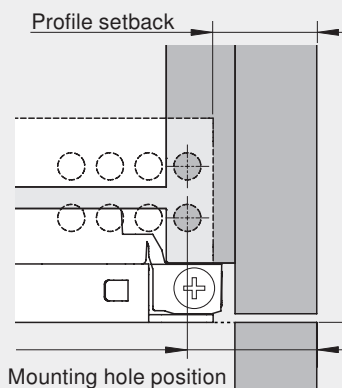

For mounting hole position, add **6mm** to profile setback

		562H Profile setback		
Sub front thickness	13 (1/2")	18	21	24
	16 (5/8")	21	24	27
	19 (3/4")	24	27	30
		16 (5/8")	19 (3/4")	22 (7/8")
		Drawer front thickness		

Setbacks shown are for drawer fronts that are flush with the face frame. For recessed drawer fronts or to allow for adjustability, the setback can be increased.

		562F Profile setback		
Sub front thickness	13 (1/2")	15	18	21
	16 (5/8")	18	21	24
	19 (3/4")	21	24	27
		16 (5/8")	19 (3/4")	22 (7/8")
		Drawer front thickness		

After installation, adjust the locking device until the drawer front is in the desired position (out adjustment only).

## Drawer preparation

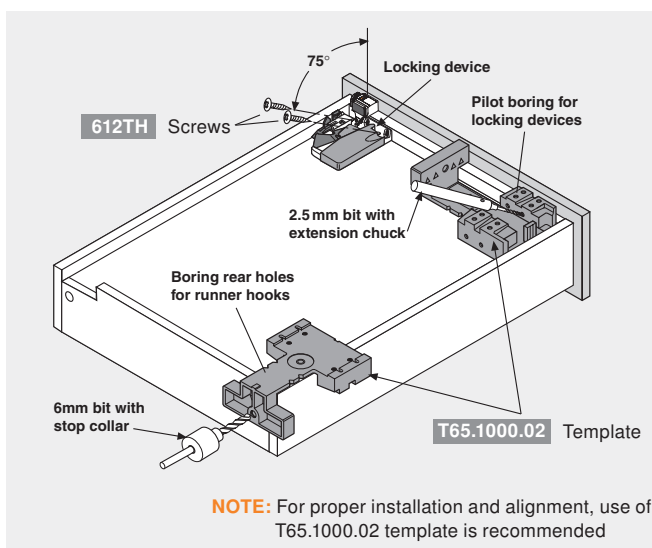

## Adjustment

Turning the adjustment screw gives up to **4mm** (3/16") out adjustment.

