

Assembly, removal and adjustment

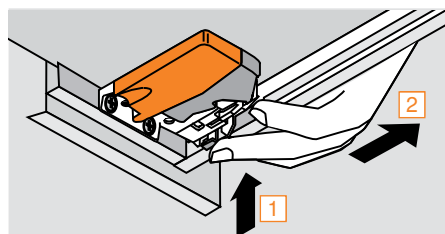

Height adjustment



- 1 Press up on adjustment latch
- 2 Push toward back of drawer

Tool-free drawer height adjustment +3

Tilt adjustment

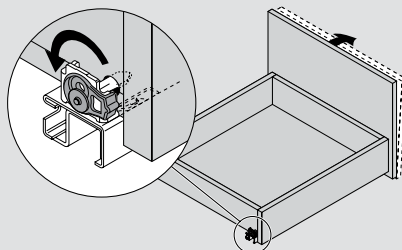

Drawer preparation

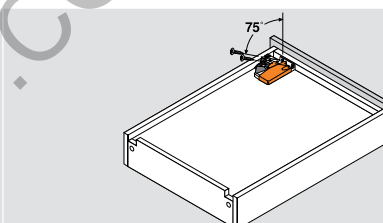
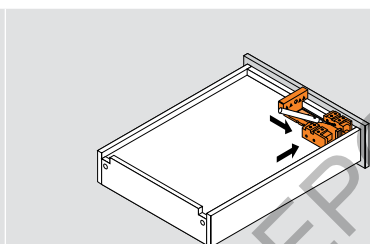
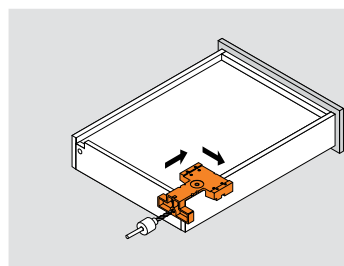

Installation screw

612TH

Drawer box insertion

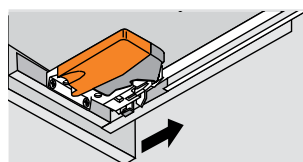

Place drawer on runners and close; locking devices will automatically engage runners.

Drawer box removal

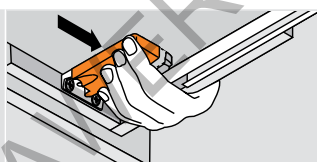

- 1 Squeeze orange handles on locking devices
- 2 Pull drawer out and up

ORGA-LINE tray set assembly

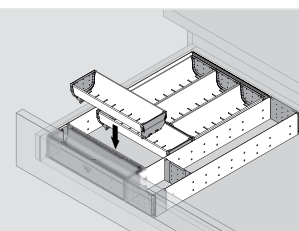
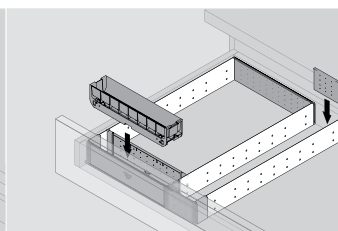
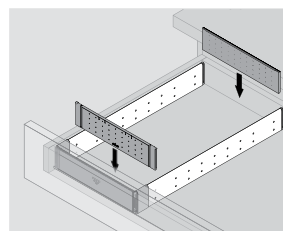

ORGA-LINE deep drawer assembly

