

## INSERTA template

- Used for installing Blum hinges with EXPANDO dowels or INSERTA
- For boring Ø8mm dowel holes after Ø35mm hole is bored
- Boring distance adjusts from 2 to 8mm
- Template for boring Ø5mm holes for system screw mounting plates
- Includes drill stop collar to pilot bore Ø2.5mm for wood screw plates

INSERTA template

**Accessories** (order separately)

Ø8mm drill bit

Ø5mm drill bit

Part no.

**65.0590**

Part no.

**DB-8mm**

**DB-5mm**

## Specifications

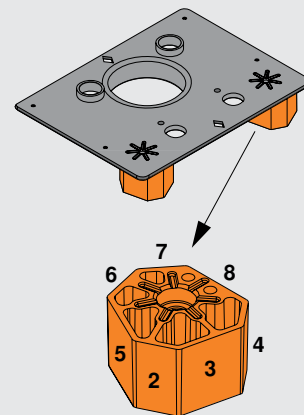
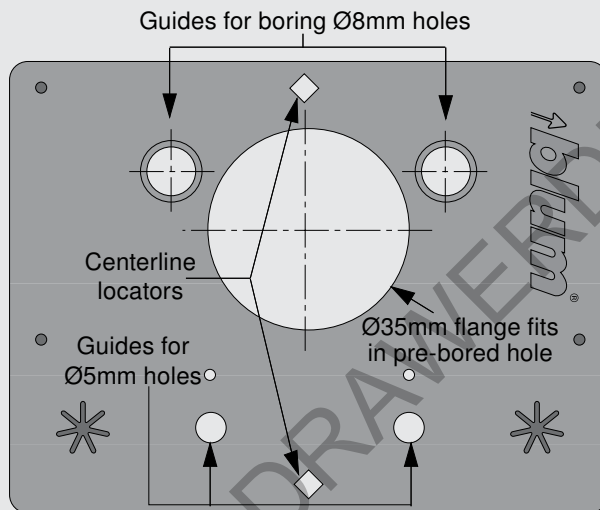

Two rotating cams provide seven boring settings for hinge cups

## Using the INSERTA template

### Using the INSERTA template for hinges

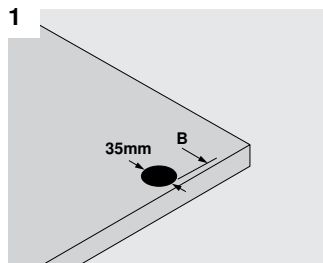

Pre-bore door with Ø35mm bit.

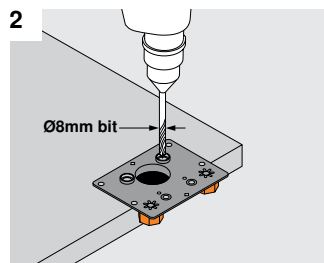

Set boring distance, position in hole and bore Ø8mm dowel holes.

### Using the INSERTA template for mounting plates

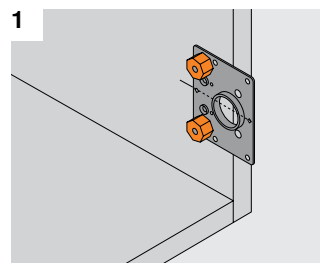

Position template on centerline.

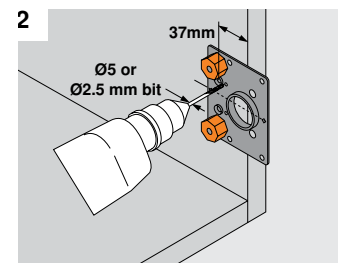

Bore holes for mounting plates with Ø5 or Ø2.5mm bit.